



# Craft-Co Enterprises - 66,000 Square Feet

## Location

3269 Highway 80 West  
Morton, MS 39117  
(Scott County)

## Property and Area Description

The former location of Craft-Co Enterprises, this 66,000 square foot facility is located in Morton in east central Mississippi. The building is divided into 51,960 square feet of manufacturing space, 8,040 square feet of warehouse, and 6,000 square feet of office space. Ceiling heights in the building range from 16 feet to 24 feet. Morton is located on Interstate 20, approximately 30 miles east of Jackson. This property is located within 2 miles of interstate 20 and is adjacent to U.S. Highway 80.

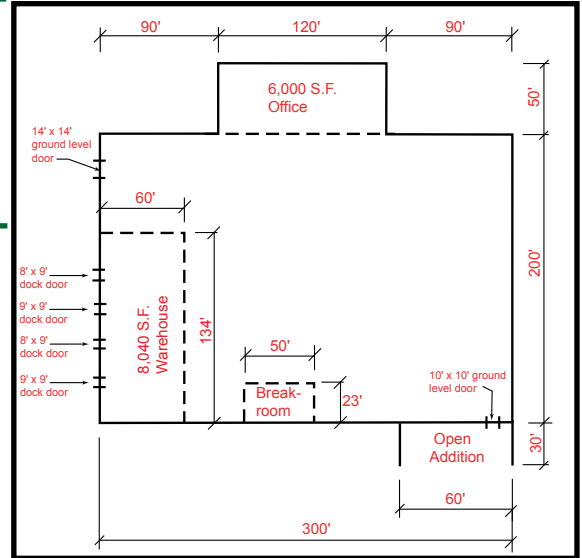

## Building Details

Total Sq. Ft.: 66,000	Former Use:
Number of Stories: 1	Automotive supplier
Ceiling Peak (ft.): 24	Building Type: Industrial
Ceiling Eaves (ft.): 16	Year Built: 1988
Expandable: Yes	Can Subdivide: Yes
Construction Type: Metal	Zoning: Light Industrial
Site Size (Acres): 12	Within City Limits: Yes

## Transportation

Nearest Interstate: Interstate 20 - 2 miles  
Nearest 4-Lane Highway: Interstate 20 - 2 miles  
Nearest Commercial Airport:  
Jackson International Airport - 25 miles  
Rail Served: No

## Utilities

Electric Distribution: Entergy  
Gas Distribution: CenterPoint Energy  
Telecommunications Local Service Provider:  
AT&T - dominant provider.  
Infrastructure to building in place.  
Sewer: City of Morton  
Water: City of Morton

## Owner

Paulette Butler

## Contact

Newt Ishee  
Mid-Mississippi Development District  
P. O. Box 119  
Newton, MS 39345  
Phone: 601-683-2091  
Fax: 601-683-2092  
Email: newt@mmdd.org  
Website: www.mmdd.org