



Stonewall Manufacturing - 21,800 Square Feet

Location

1001 Industrial Place
Stonewall, MS 39363
(Clarke County)

Property and Area Description

This building was most recently occupied by a call center. The building is located in east central Mississippi. This facility features approximately 19,000 square feet of open area, 2,700 square feet of office space and a ceiling clearance of 20 feet. Roughly half the building has been reconfigured as a 100 seat call center. This building is both copper and fiber fed and is capable of meeting virtually any communications need. Additional features of the building include a reinforced concrete floor and air conditioning. Stonewall is located approximately 18 miles south of Meridian, Mississippi, and 7 miles east of Interstate 59.

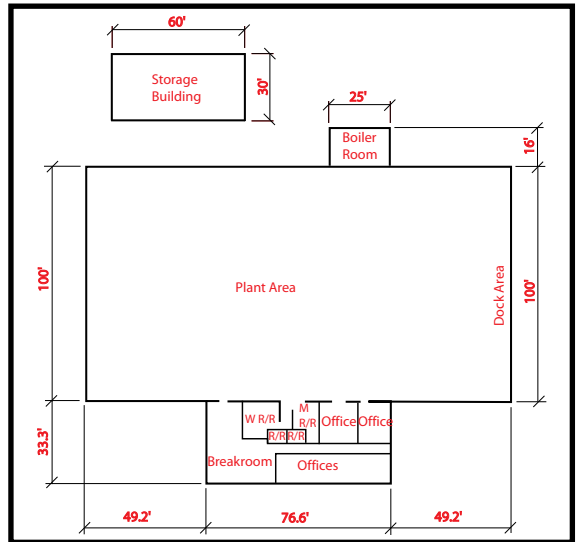

Building Details

Total Sq. Ft.: 21,800	Former Use: Electronics
Number of Stories: 1	Manufacturing; Call Center
Ceiling Peak (ft.): 20	Building Type: Industrial
Ceiling Eaves (ft.): 15	Year Built: 1990
Expandable: Yes	Can Subdivide: Yes
Construction Type: Metal	Zoning: Light Industrial
Site Size (Acres): 5.0	Within City Limits: Yes

Transportation

Nearest Interstate: Interstate 59 - 7 miles
 Nearest 4-Lane Highway: U. S. Highway 45 - 6 miles
 Nearest Commercial Airport:
 Meridian Regional Airport - 18 miles
 Rail Served: No

Utilities

Electric Distribution: Mississippi Power Company
 Gas Distribution: CenterPoint Energy
 Telecommunications Local Service Provider:
 AT&T - dominant provider.
 Infrastructure to building in place.
 Sewer: Town of Stonewall
 Water: Town of Stonewall

Owner

Town of Stonewall

Contact

Newt Ishee
 Mid-Mississippi Development District
 P. O. Box 119
 Newton, MS 39345
 Phone: 601-683-2091
 Fax: 601-683-2092
 Email: newt@mmdd.org
 Website: www.mmdd.org